

## Notes:

1. Cross Section: 18AWG
2. Maximum Electric Current: 18AMP
3. Maximum Electric Rating: 105°C
4. Voltage Rating: 2000V
5. Terminal Material: Copper
6. Terminal Surface Treatment: Tin Plating

### Standard (Metric)

L1: 8.0mm (0.31")  
D: 1.7mm (0.06")  
D1: 1.4mm (0.05")  
D2: 2.5mm (0.09")

### Tolerances

(Unless Otherwise Specified)

#### CATEGORY

Non Insulated Wire Ferrules

#### SCALE

1-1

#### PART #

N10008

#### MATERIAL

Tin-Plated Copper

#### PAGE

10F2



# FerrulesDirect

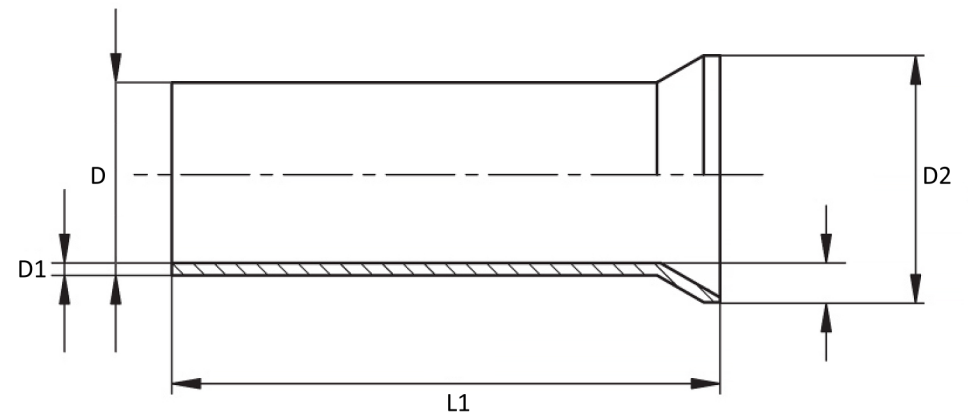

For applicable tools, visit our website: [www.FerrulesDirect.com](http://www.FerrulesDirect.com)